

Cutting and bending machine

Type C055 S

Translation of the original operating manual

Streckfuss USA

Retention of title

We reserve all rights for this document.
It may not be duplicated or made accessible to third parties
without our consent.

This documentation and the information contained therein
have been compiled with the appropriate care.

The company Streckfuss USA however shall not accept
responsibility for typing and other errors
or damages resulting therefrom.

Version: 1.0

Date of issue: October 2022

Author: Streckfuss USA
PO Box 140008
Dallas, TX 75214 USA
Tel. +1 972 790 1614
E-Mail: sales@streckfuss.com
Internet: www.streckfuss.com

Streckfuss USA
PO Box 140008
Dallas, TX 75214
USA
Tel. +1 972 790 1614

E-Mail: sales@streckfuss.com
Internet: www.streckfuss.com

EC Declaration of Conformity In according to EC Machinery Directive 2006/42/EG Appendix II A

We herewith declare that the machine described hereinafter satisfies the essential safety and health requirements set out in the EC Machinery Directive with regard to its design and construction as well as the type marketed by us.

In case of an alteration of the machine without our agreement this declaration shall become void.

We furthermore point out that for the installation of spare parts only original parts of the company Streckfuss USA may be used.

Description of the machine:	Cutting and bending machine
Machine type:	C 055 S
Machine number:	22.10.739
Applicable directives:	EC Machinery Directive (2006/42/EG appendix II A) EC Electromagnetic Compatibility Directive (2014/30/EG)
Applied harmonized standards, particularly:	EN ISO 12100:2010 DIN EN 13857
Attachment of the CE label:	CE
Place/Date/Signature:	Karlsruhe, den 24.10.2022 

Managing director

General Information

1. Notes on industrial safety

The following notes on industrial safety have to be specially adhered to:

- The cutting machine C055 S has been constructed according to the current state of the art and conforms to the ESD regulations. Nevertheless, perils may arise from this device if it is used by untrained personnel or for other than the intended purposes.

- **Statement on the residual risk**

1. Danger of contusion and shearing during set up operation.

The danger areas are marked with signs.



- Applicable accident prevention regulations have to be adhered to by the user, particularly the
 - DGUV-Regulation 1
- The device may only be operated by trained personnel.
- Any mode of operation which can impair the safety of the device has to be refrained from.
- The user undertakes to operate the device only in perfect condition.
- Unauthorised alterations or variations which impair safety have to be refrained from.
- Safety devices may principally not be dismantled or put out of operation. If it is indispensable to dismantle safety devices for the purpose of tool changes or for maintenance and repair work, the safety device has to be reinstalled immediately afterwards.

2. Table of contents

	Page
General Information	4
1. Notes on industrial safety.....	4
2. Table of contents	5
3. General description.....	6
4. Technical Data	6
Commissioning.....	7
1. Installation and connection	7
2. Working with the machine.....	7
Retool.....	8
1. General comments on the adjustment of the machine.....	8
2. Retooling plate sets	8
Faults and their Rectification.....	9
Maintenance.....	10
1. Maintenance Plan	10
Spare parts catalogue	11
1. Part list basic parts C055	11
2. Exploded basic parts C055	12
3. Drawing and parts list C055 S	13
4. Pneumatic plan C055 S	14

3. General description

The cutting machine C055 S is designed for cutting and bending component leads on length.

The cutting machine works from the left side to the right side.

The component has to be put in the slot.

With the foot valve, the operation is triggered.

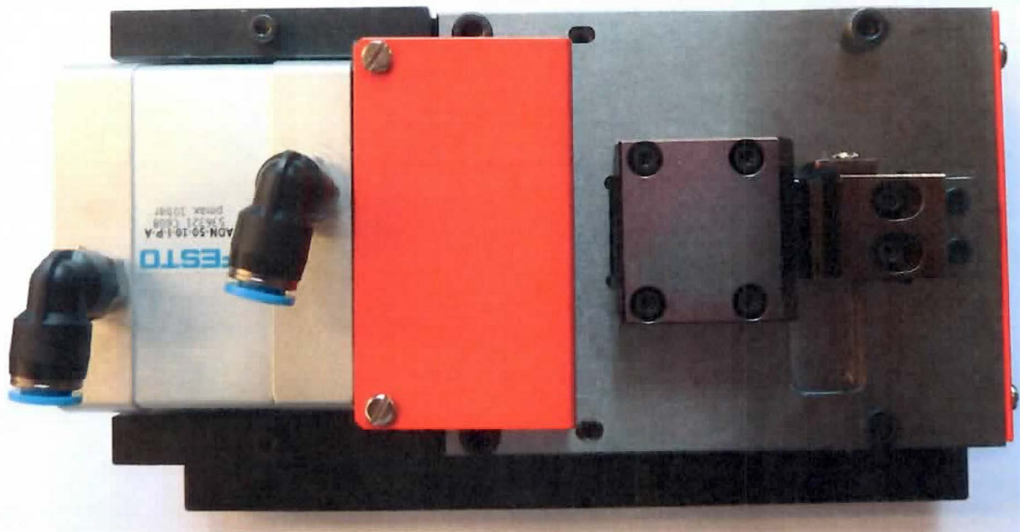

Fig. 1

Cutting and bending machine C055 S
(Similar to illustration)

4. Technical Data

Dimensions Without foot valve	Width:	120 mm
	Depth:	190 mm
	Height:	120 mm
Weight:		app. 4 kg
Air pressure		6 bar
Operating		pneumatic hand valve

Commissioning

1. Installation and connection

The machine will be delivered ready assembled. Foot switch and connection-tube are attached to the device and have to be connected by the customer according to the enclosed pneumatic diagram. We recommend to integrate a service unit with pressure controller into the connection-tube. Air pressure should be 6 bar. Put the machine on a suitable working-area and put the foot valve on the ground in a convenient position for the operator.

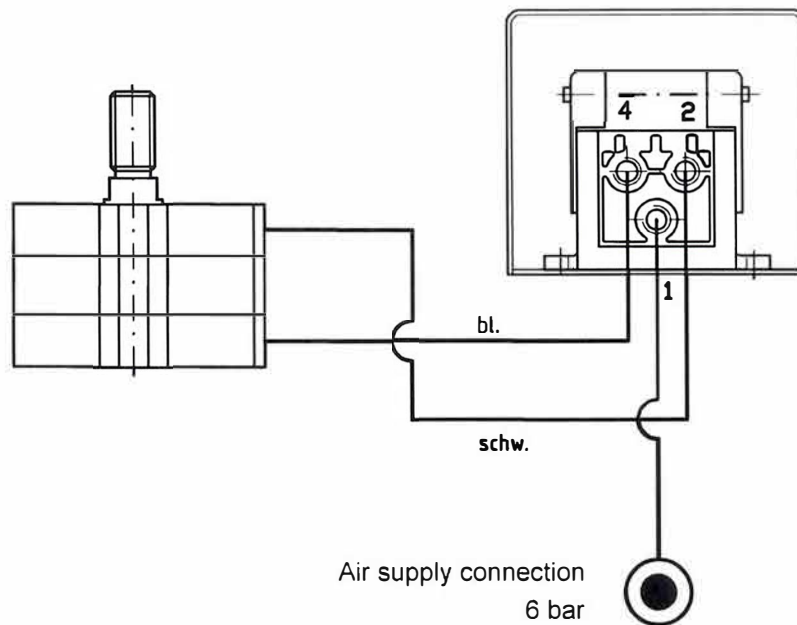

Fig. 2
Connection Diagram

2. Working with the machine

Please take care, that component is put completely into the machine, which means until the lower edge of the component body. This is very important to achieve always the same cutting length. The cutting procedure will released afterwards by the foot valve.

Retool

1. General comments on the adjustment of the machine

- Secure the machine, in case of modification or service-work on it, against a no unintentional (unauthorized) switching can be carried out.

Switch off compressed air

- Please make sure that all screws will be tighten again, after having finished the settings although this is not explicitly mentioned in the following text.
- The machine is equipped to the length by the factory. To prevent damage, setting changes must be carried out carefully by means of existing instruction by qualified personnel.



2. Retooling plate sets

For the safety the plate set has to be fixed with a screw (M3). Loose the screw which next to the cylinder and screw it in the whole as shown in figure 3.

Unscrew the orange protective cap. To replace the disk set screw using the 4 allen screws from the plate set of the machine. Mount the new disk set in reverse order. After the above is done, the machine has to be carefully re-mounted.

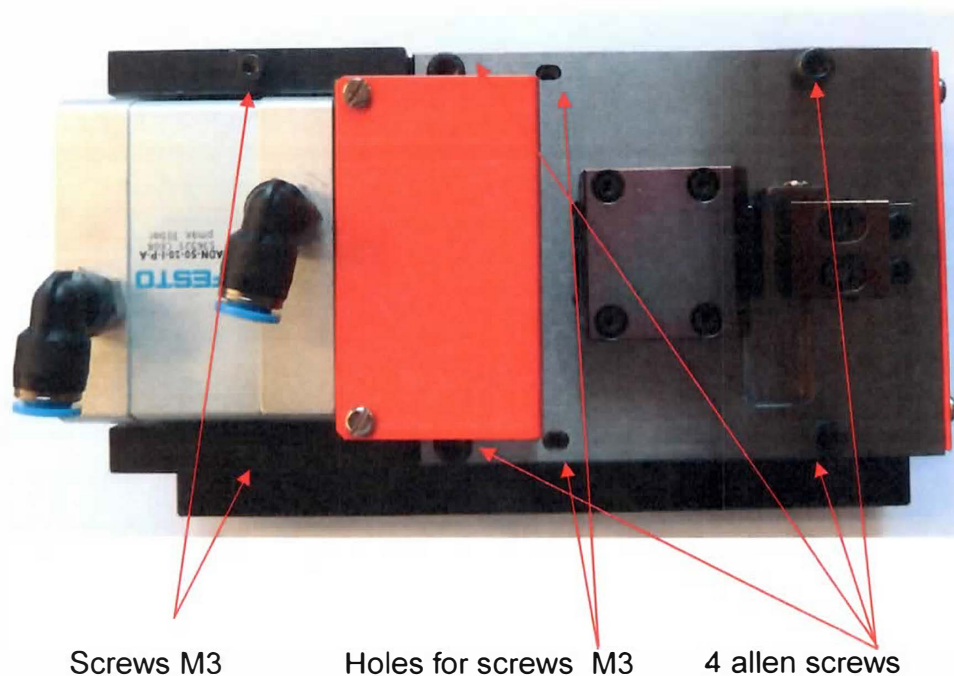

Fig. 3
(Similar to illustration)

Faults and their Rectification

Caution: All maintenance and repair work may only be performed by qualified and trained personnel!

If used properly, the machine will function virtually without trouble. If, contrary to expectation, faults should occur, please inform your supplier first.

Your contact: **Streckfuss USA, Tel. +1 972 790 1614**

The type of fault discussed consequently can be taken down in the following table with the description of causes and measures for the correction of the faults.

Type of fault	Cause	Measures

Maintenance

1. Maintenance Plan

Operating hours / Period	Maintenance Instructions
daily	By using a brush clean the device of waste leads and other garbage.
monthly	Clean all sliding parts and oil lightly. No grease.

Note:

All maintenance and repairs should be performed only by qualified personnel!

Note:

To lubricate the moving and sliding parts, it is not allowed to use grease! Please only low-viscosity lubricants, such as gun oil, sewing machine oil, or for example "WD-40" use.



Spare parts catalogue

Cutting machine

C055 S

1. Part list basic parts C055

Pos.	Piece	Item	Drawing number
1	1	Base plate	C055 H T.1
2	2	Side panel left and right	C055 H T.2
11	1	Mounting plate	C055 H T.11
12	1	Guide pin	C055 H T.12
13	1	Cover	C055 H T.13
22	4	rubber feet	
23	1	Short stroke cylinder ADN-50-10-I-P-A	
	1	Foot valve F-5-¼ -B	

2. Exploded basic parts C055

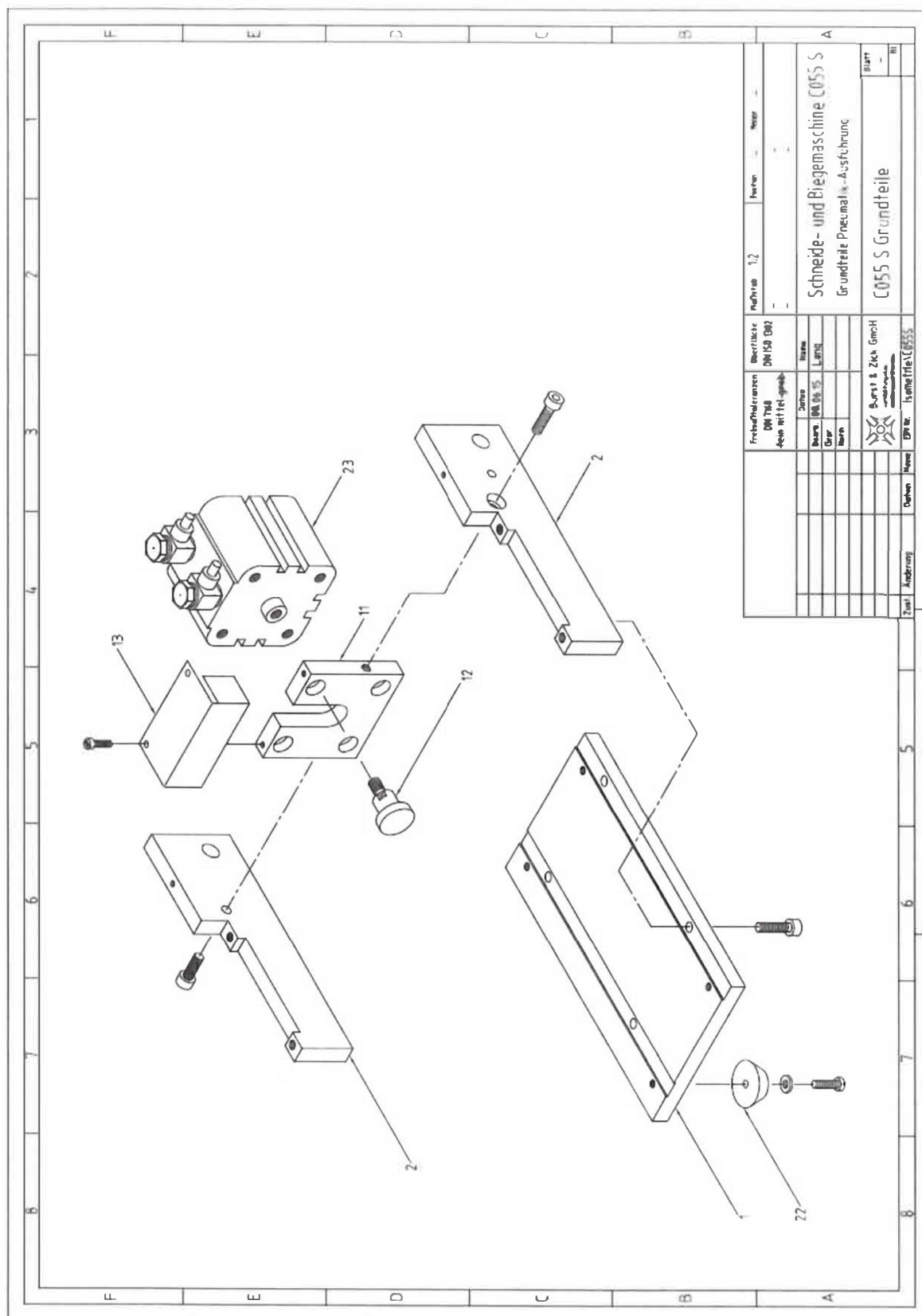



4. Pneumatic plan C055 S

ADN 50-10-I-P-A

